

Haystack Connect 19

Padi Pitch



The Future of Building IoT...

- Users will need to manage dozens/hundreds of devices and systems on a daily basis.
- Users will need to collaborate with many other users: vendors, co-workers, customers, etc.
- Users will need to manage many notifications from systems and other users.

Padi Addresses These Challenges

In a single pane of glass, on the Internet!



Try Padi yourself

PADI

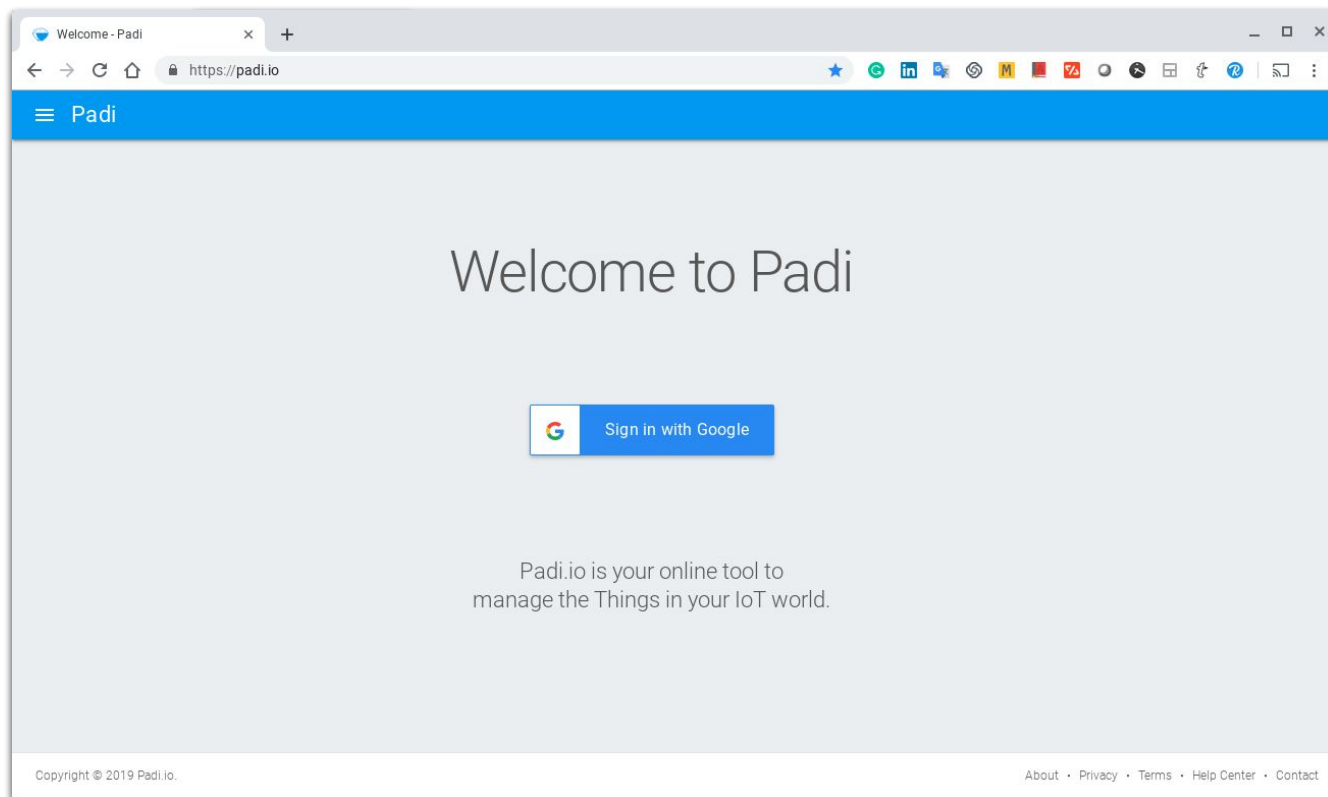

Visit Padi by going to **padi.io**

Log in using any Google account.

Your Padi Homepage



Home - Padi

https://padi.io/#home

Padi

Padi Shares

Teams & People

Padi Shares OPEN

Collections & Things

Transportation in London
London, United Kingdom

Really Live Map

Anto's Padi Profile

Browser Status

Notifications

- Anto added London Bus #49
24 days ago
- Busy in Waterloo today!
25 days ago
- Yes, just like Pacman
29 days ago
- Anto (Padi) is now a collaborator in
Transportation in London
1 month ago
- Padi Shares is now a collaborator in
Really Live Map
1 month ago
- Anto Budiardjo has shared Really Live
Map with Padi Shares
1 month ago
- Anto Budiardjo modified
Transportation in London
1 month ago

Your
Homepage is
your place to
manage your

- Teams
- Things
- Notifications

Create a Team

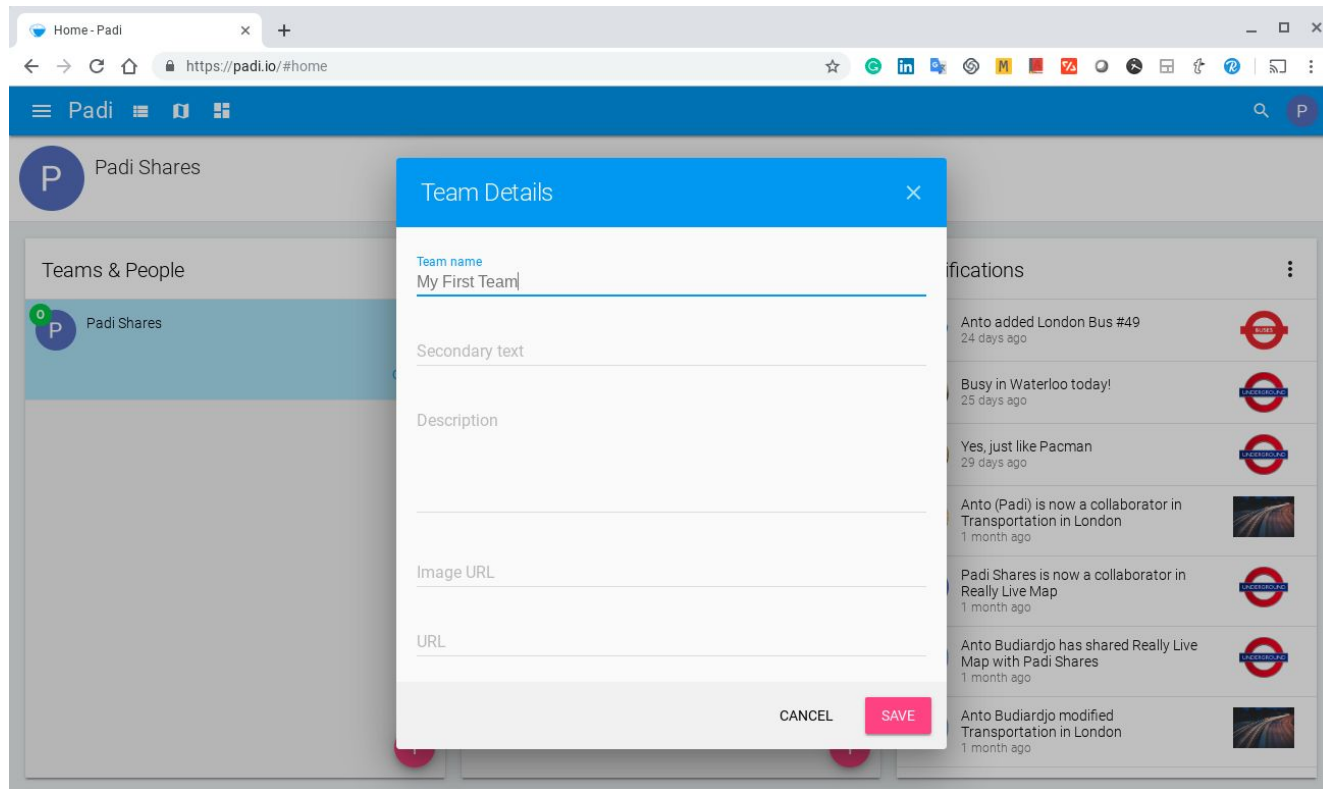

Click on the + button on the Teams & People column to create your first Team!

Now you have a Team!

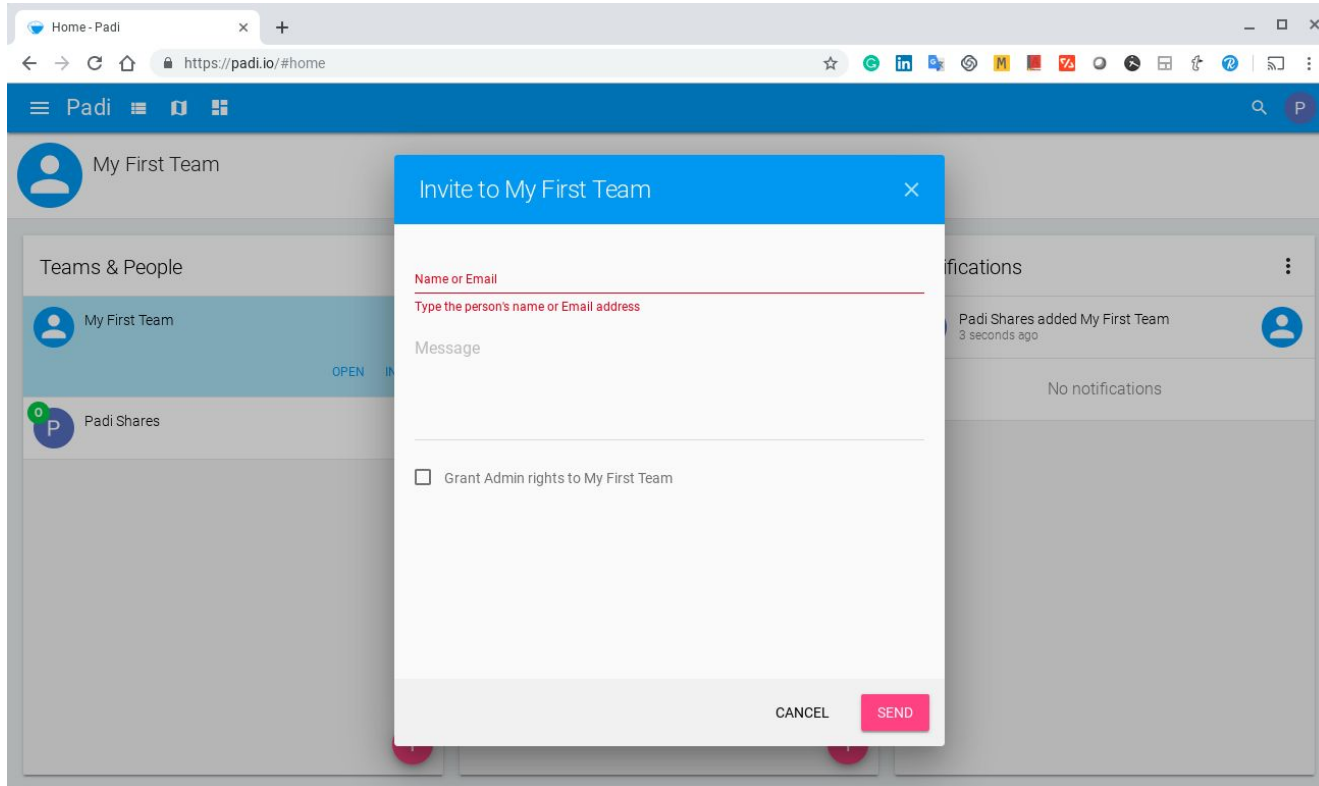

You can Invite other people to your Team.

Send them a message.

You can also make them a Team Admin!

Now Add an App to your Team

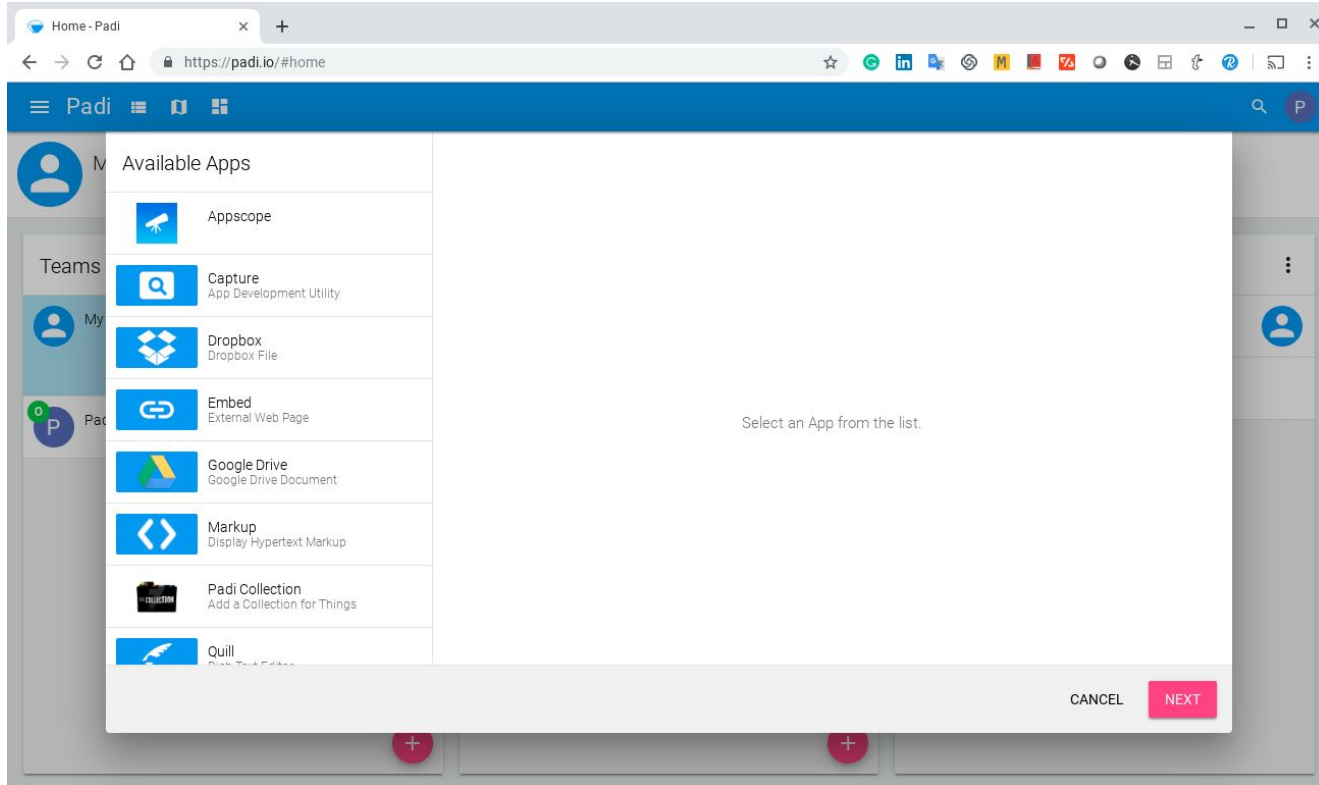

Click on the + button on the middle to install your first Padi App! Select Quill from available Apps.

Provide a name and other info

A screenshot of a web browser window showing a form for providing app information. The browser's address bar displays "https://padi.io/#home". The form is titled "Padi" and contains the following fields:

- Thing name:** Read me
- Address or secondary text:** Some text for users to read
- Description:** A large text area with a blue horizontal line and a green circular icon on the right.
- Image URL:** A text input field.

At the bottom right of the form, there are two buttons: "CANCEL" and "NEXT".

If prompted,
provide a
name of this
App.

Then click
Next.

Configure the App

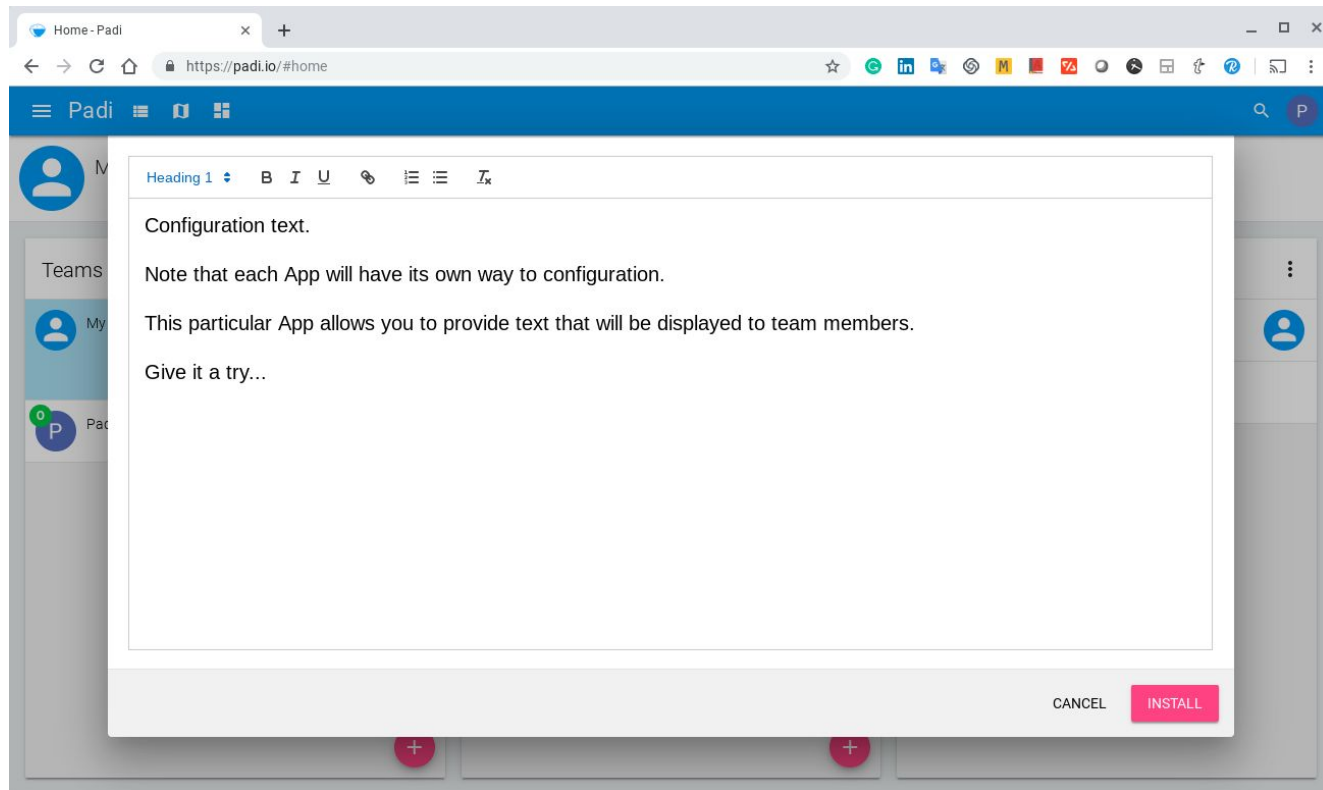

Most Apps will require some configuration. In this App, it's just text.

Once done, click Install.

See the App in Action!

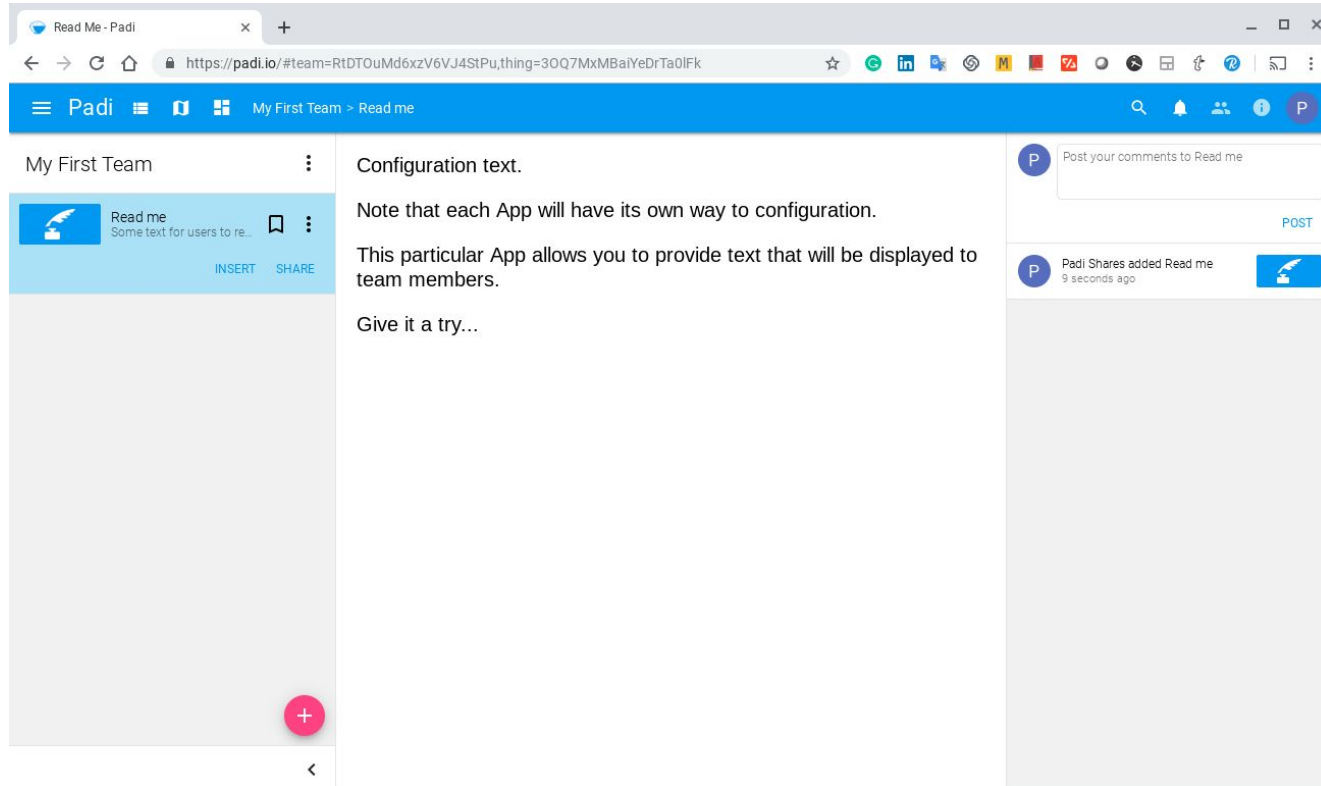

Once the App is added, click to see and Open the App. Your Team can now see the App.

Thank you for trying Padi

Note: Padi is now in Beta

Questions? Contact anto@padi.io

